

Vectra GL Liquid Ring Vacuum Pumps & Compressors



Vectra GL vacuum pumps and compressors are designed to deliver outstanding reliability and performance for general industrial applications.

Built-in mechanical seals, direct drive speeds for 60Hz and 50Hz power sources and a broad capacity range are some of the features that separate the Vectra GL from the competition.

In addition, cone angles have been optimized to reduce the size of the pump. And Gardner Denver Nash's patented Gas Scavenging Technology dramatically improves pump performance at high vacuum levels.

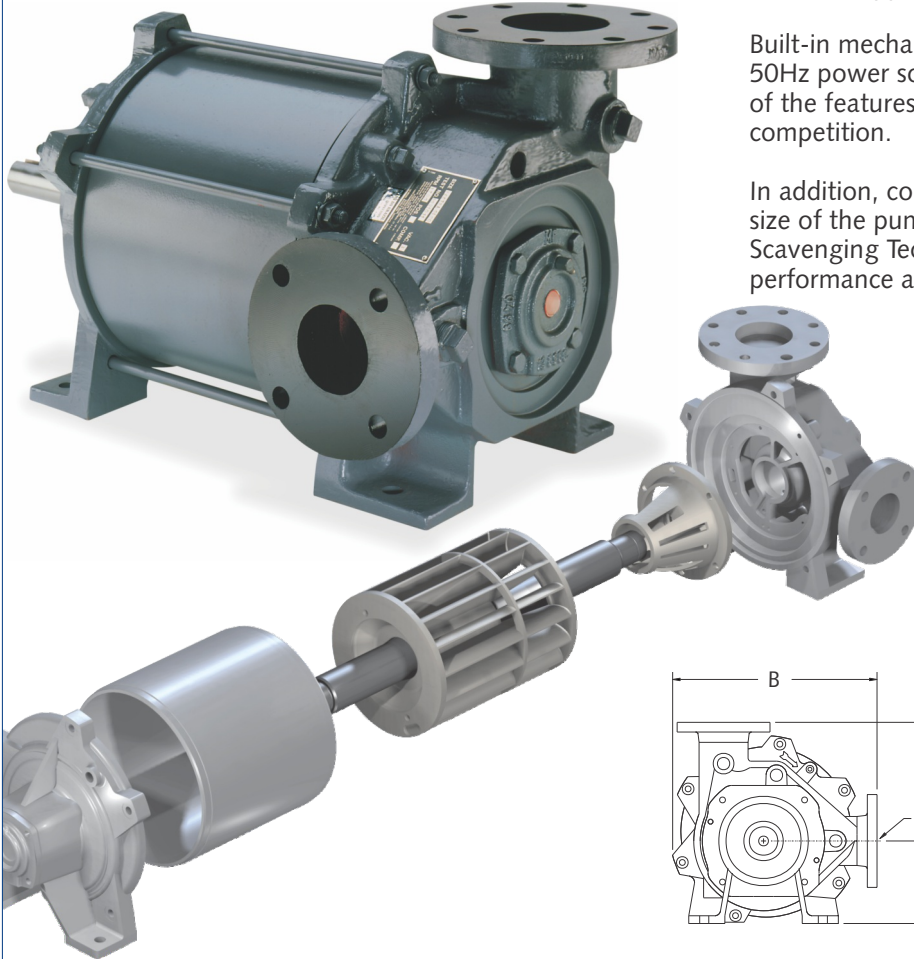

Basic specifications

Vacuum range	0-29 in Hg Vac. to 33 mbar abs.
Mechanical seals	Single
Differential pressure capability	15 psig 1 bar
Hydrotest pressure	75 psig / 6 bar abs. standard
Construction material	Ductile iron

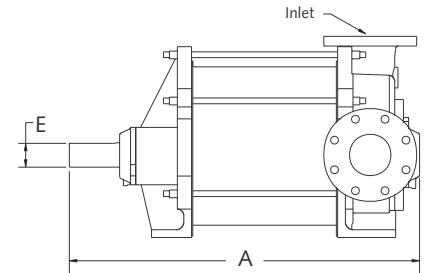
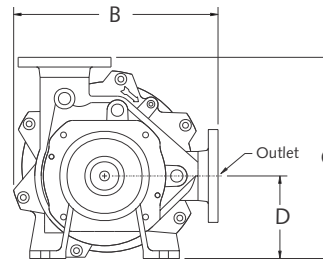

Performance

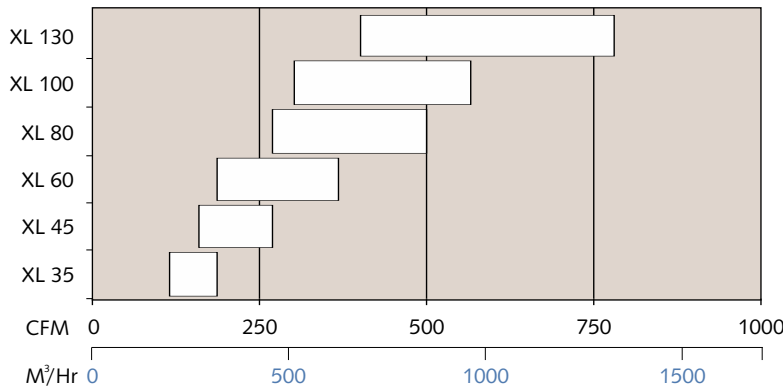

Dimensions

mm in blue

Pump	A	B	C	D	E	Inlet	Outlet
GL 35	21 533	13.4 340	14 356	6 152	1.3 33	3 in. FLG. 80mm FLG.	2 in. FLG. 50mm FLG.
GL 45	24 610	13.4 340	14 356	6 152	1.3 33	3 in. FLG. 80mm FLG.	2 in. FLG. 50mm FLG.
GL 60	27 686	17 432	16 406	6.8 173	1.6 41	4 in. FLG. 100mm FLG.	3 in. FLG. 80mm FLG.
GL 80	31 787	17 432	16 406	6.8 173	1.6 41	4 in. FLG. 100mm FLG.	3 in. FLG. 80mm FLG.
GL 100	30 762	19 483	20 508	8 203	1.9 48	4 in. FLG. 100mm FLG.	4 in. FLG. 100mm FLG.
GL 130	34 864	19 483	20 508	8 203	1.9 48	4 in. FLG. 100mm FLG.	4 in. FLG. 100mm FLG.

All dimensions are approximate

NASH - Division of Gardner Denver

phone: +1 800 553 NASH · +1 724 239 1500 · fax: +1 203 459 3988 · email: nash@gardnerdenver.com

GDNash.com